

DEMO TOUCHVUE

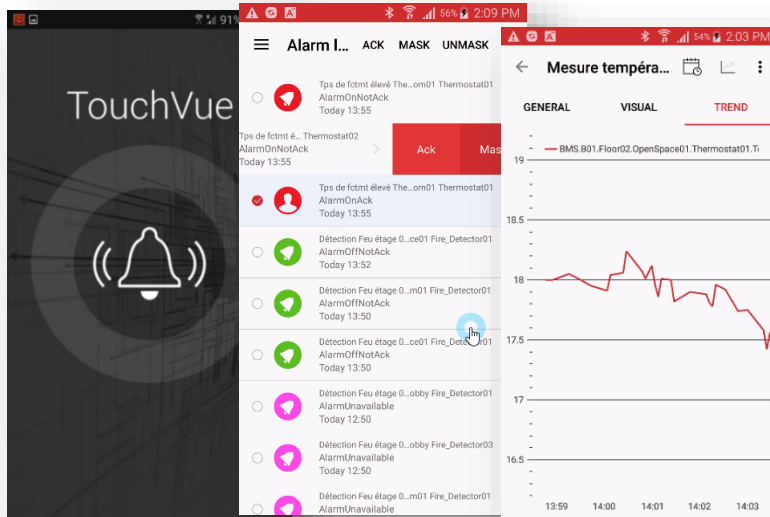

TouchVue is an app notifying mobile users of any event on the process and providing an interface to react in a timely fashion. It relies on the latest technologies offering a cost-effective solution combining ergonomics, security and ease of implementation.



A server for demonstration is available

1 - Open TouchVue

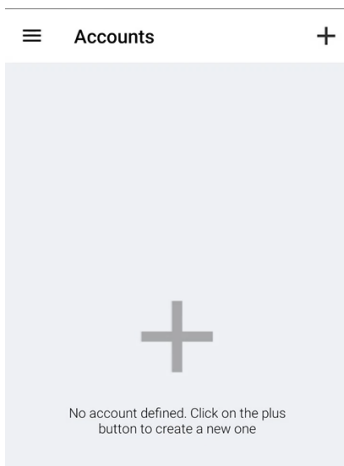

2 - Add a server

3 - Connect

User/Pwd
Maint_en/Maint_en

4 - Test

Notifications

Preferred variables

Real-time variables

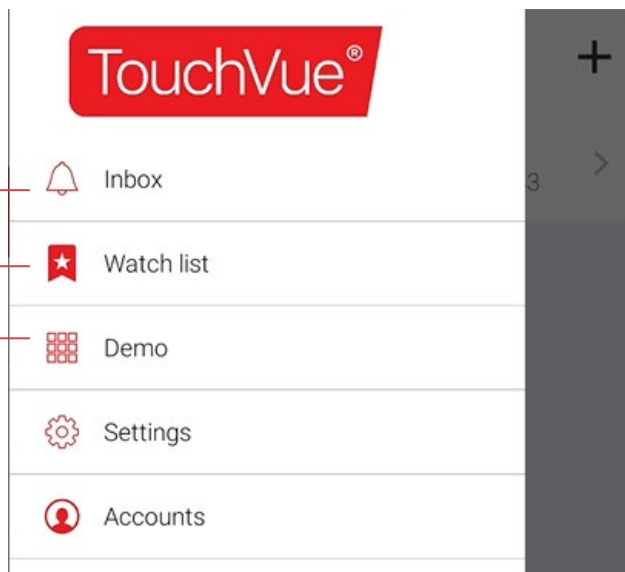

Tap on Demo

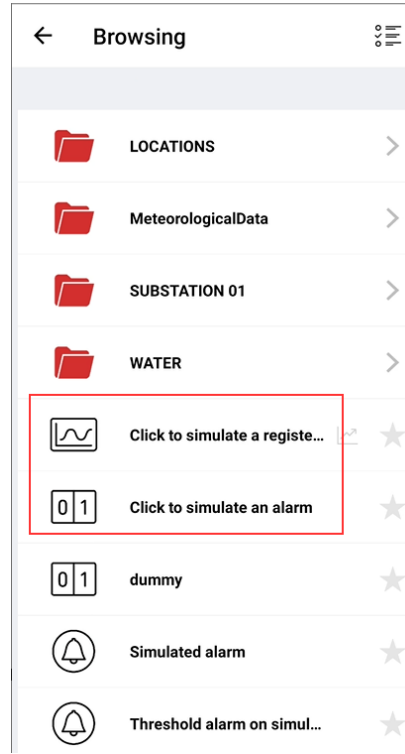
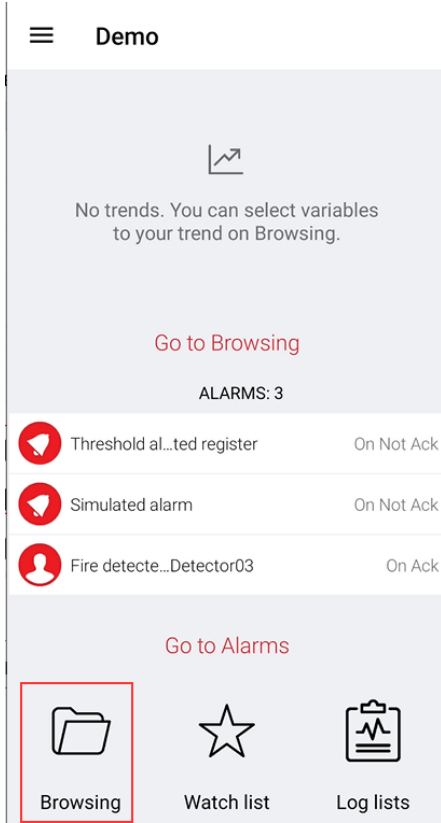

Tap on the simulation variables

← Demo

0 1 Click to simulate an alarm

Animation 0

Quality: **Valid** Timestamp: 1/12/2021 1:44:52 PM

GENERAL PROPERTIES

Domain	CMD
Nature	FIRE_I...ENDIE

General •

Set Value

Command 0

Command 1

CANCEL

Simulated alarm
On Not Ack

0 1 Click to simulate an alarm

Animation 1

Quality: Timestamp:

Enter a value >25 to trigger a threshold

← Demo

Click to simulate a register value

31
m3/s

Quality: **Valid** Timestamp: 1/12/2021 1:26:15 PM

GENERAL PROPERTIES

Domain	PUMP...MPE1
Nature	FLOW...ETRE
Minimum value	0
Maximum value	50

General ••

Demo
Simulated alarm: On Not Ack Threshold alarm on sim..

Set Value

- **31** +

0 50

Apply